

PUBLIC



# SVĚT WEBDISPEČINKU

## 5/2026

[www.webdispecink.cz](http://www.webdispecink.cz)

## CONTENTS OF THE ISSUE

<b>The old mobile app labeled "legacy" will stop working</b>	<b>3</b>
<b>We've released a new version of the WD Fleet app</b>	<b>4</b>
<b>New bulk export</b>	<b>7</b>
<b>Archiving of log book data in Slovakia</b>	<b>8</b>
<b>End</b>	<b>9</b>



Redakce

Adresa redakce:

Princip a.s.

Na Vítězné pláni 1719/4

140 00 Praha 4 – Nusle

Redakční email:

[webdispecink.tlm@eurowag.com](mailto:webdispecink.tlm@eurowag.com)

## REPEATED NOTICE – The old mobile application labeled “legacy” will stop working

Dear clients,

We would like to remind you once again that the old version (1.x.x) of the Webdispecink mobile app (legacy) will stop working at the end of May 2026.

We have informed you about this risk in the past (about three years ago), but we have noticed that some of you are still using the old application.

For this reason, we kindly ask you to upgrade to the new version of the app (2.x.x) as soon as possible, as it is fully supported and offers improved features.

This new version was released in 2023 and is available on Google Play and the Apple App Store.

Google Play (Android):  
<https://play.google.com/store/apps/details?id=cz.hisoftware.webdispecink>

Apple App Store (iOS):  
<https://apps.apple.com/cz/app/webdispecink/id1555253517>

If you are already using the new version, you can ignore this notice.

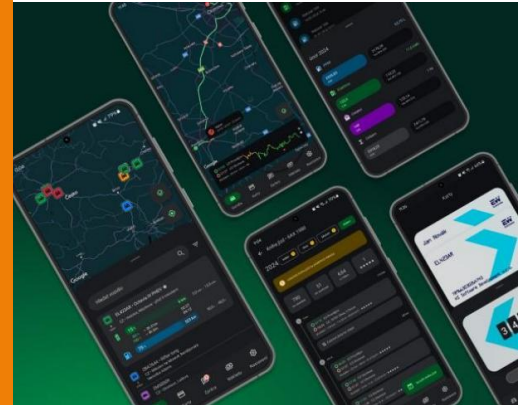

# NEWS – We've released a new version of the WD Fleet app

## What's new in version 1.10.6:

- New settings for automatic log
- Basic function settings - Default actions for automatic creation of activity log - it is possible to set an action for stopping and an action for driving

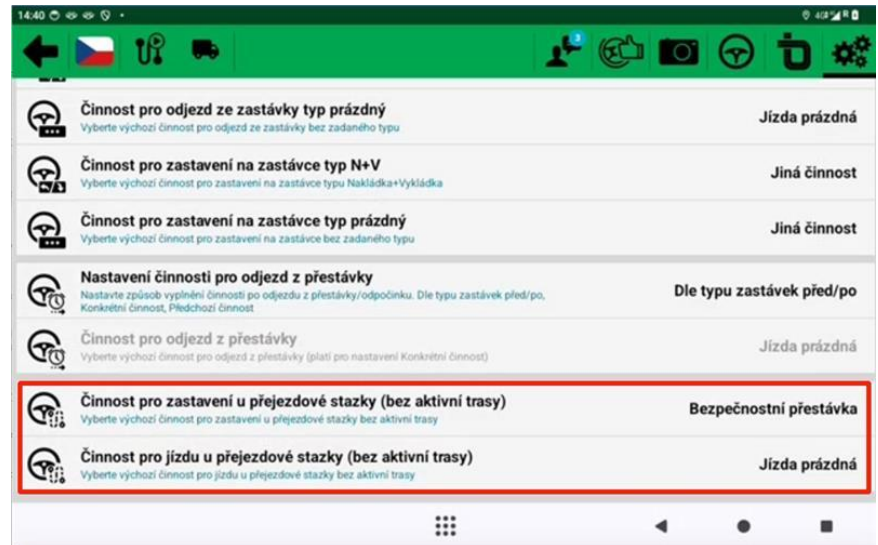

## NEWS – We've released a new version of the WD Fleet app

- Estimated time of arrival (ETA) at all stops along the route, including AETR
- For each stop, we now display the current estimated time of arrival (ETA) based on the navigation system, as well as the estimated time of arrival (ETA) calculated using the driver's AETR



## NEWS – We've released a new version of the WD Fleet app

- **Increase the data limit for Traffic in Sygic navigation**

We have increased the data limit for real-time traffic in Sygic Navigation from 200 MB to 300 MB per month, and along with that, the number of hours of navigation usage to 330 hours.

- **Various bug fixes and improvements to the app's stability**

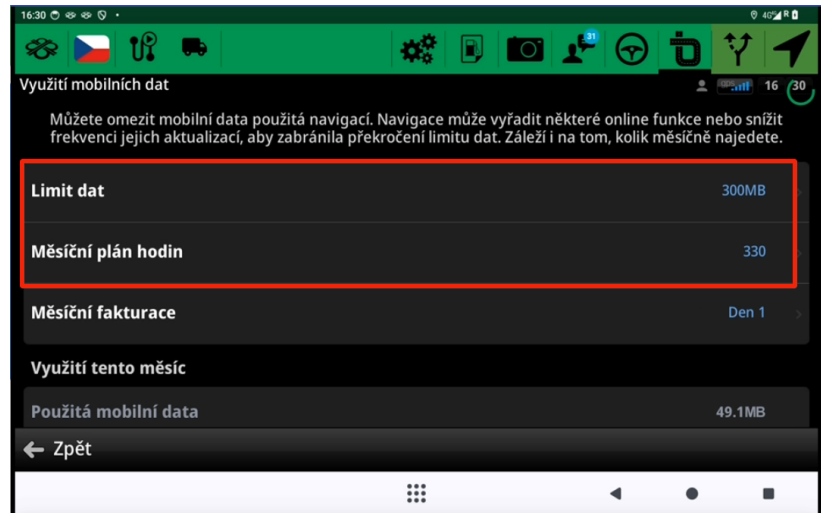

# NEWS – New bulk export

Among the bulk exports  
A new option has been added to  
"Vehicle Statistics Exports" – **Vehicle Statistics Including Cost Centers.**

This export is based on the "Vehicle Statistics" export, but has a modified number of columns. The export includes dynamic columns showing the centers and the number of business kilometers driven at each center. These columns are at the very end.

Vehicle statistics including cost centers

Date from		01.04.2020 00:00		Date to		30.04.2020 23:59		Group		all groups	
Vehicle	Group	Period	October 2019	October 2019	mileage	Business km	Cost	Center	Cost	Center	Cost
000000	000000	000000	2476,00	2476,00	2476,00	0,00	2476,00	000000	2476,00	000000	2476,00
000001	000001	000001	82719,00	80591,00	4236,00	164,00	2592,00	000001	82719,00	000001	80591,00
000002	000002	000002	47000,00	47000,00	2000,00	120,00	2000,00	000002	47000,00	000002	47000,00
000003	000003	000003	80306,46	82390,83	2784,37	399,42	2384,95	000003	80306,46	000003	82390,83
000004	000004	000004	21009,41	20212,11	1163,30	2,44	1152,85	000004	21009,41	000004	20212,11
000005	000005	000005	202429,71	209896,39	7227,27	0,00	7227,27	000005	202429,71	000005	209896,39
000006	000006	000006	62020,00	62020,00	2200,00	0,00	2200,00	000006	62020,00	000006	62020,00
000007	000007	000007	82228,27	84332,11	2203,84	829,82	1463,02	000007	82228,27	000007	84332,11
000008	000008	000008	90717,00	91117,00	412,00	868,00	3426,27	000008	90717,00	000008	91117,00
000009	000009	000009	10209,00	10209,00	0,00	0,00	0,00	000009	10209,00	000009	10209,00
000010	000010	000010	10209,00	10209,00	0,00	0,00	0,00	000010	10209,00	000010	10209,00
000011	000011	000011	10209,00	10209,00	0,00	0,00	0,00	000011	10209,00	000011	10209,00
000012	000012	000012	10209,00	10209,00	0,00	0,00	0,00	000012	10209,00	000012	10209,00
000013	000013	000013	10209,00	10209,00	0,00	0,00	0,00	000013	10209,00	000013	10209,00
000014	000014	000014	10209,00	10209,00	0,00	0,00	0,00	000014	10209,00	000014	10209,00
000015	000015	000015	10209,00	10209,00	0,00	0,00	0,00	000015	10209,00	000015	10209,00
000016	000016	000016	10209,00	10209,00	0,00	0,00	0,00	000016	10209,00	000016	10209,00
000017	000017	000017	10209,00	10209,00	0,00	0,00	0,00	000017	10209,00	000017	10209,00
000018	000018	000018	10209,00	10209,00	0,00	0,00	0,00	000018	10209,00	000018	10209,00
000019	000019	000019	10209,00	10209,00	0,00	0,00	0,00	000019	10209,00	000019	10209,00
000020	000020	000020	10209,00	10209,00	0,00	0,00	0,00	000020	10209,00	000020	10209,00
000021	000021	000021	10209,00	10209,00	0,00	0,00	0,00	000021	10209,00	000021	10209,00
000022	000022	000022	10209,00	10209,00	0,00	0,00	0,00	000022	10209,00	000022	10209,00
000023	000023	000023	10209,00	10209,00	0,00	0,00	0,00	000023	10209,00	000023	10209,00
000024	000024	000024	10209,00	10209,00	0,00	0,00	0,00	000024	10209,00	000024	10209,00
000025	000025	000025	10209,00	10209,00	0,00	0,00	0,00	000025	10209,00	000025	10209,00
000026	000026	000026	10209,00	10209,00	0,00	0,00	0,00	000026	10209,00	000026	10209,00
000027	000027	000027	10209,00	10209,00	0,00	0,00	0,00	000027	10209,00	000027	10209,00
000028	000028	000028	10209,00	10209,00	0,00	0,00	0,00	000028	10209,00	000028	10209,00
000029	000029	000029	10209,00	10209,00	0,00	0,00	0,00	000029	10209,00	000029	10209,00
000030	000030	000030	10209,00	10209,00	0,00	0,00	0,00	000030	10209,00	000030	10209,00
000031	000031	000031	10209,00	10209,00	0,00	0,00	0,00	000031	10209,00	000031	10209,00
000032	000032	000032	10209,00	10209,00	0,00	0,00	0,00	000032	10209,00	000032	10209,00
000033	000033	000033	10209,00	10209,00	0,00	0,00	0,00	000033	10209,00	000033	10209,00
000034	000034	000034	10209,00	10209,00	0,00	0,00	0,00	000034	10209,00	000034	10209,00
000035	000035	000035	10209,00	10209,00	0,00	0,00	0,00	000035	10209,00	000035	10209,00
000036	000036	000036	10209,00	10209,00	0,00	0,00	0,00	000036	10209,00	000036	10209,00
000037	000037	000037	10209,00	10209,00	0,00	0,00	0,00	000037	10209,00	000037	10209,00
000038	000038	000038	10209,00	10209,00	0,00	0,00	0,00	000038	10209,00	000038	10209,00
000039	000039	000039	10209,00	10209,00	0,00	0,00	0,00	000039	10209,00	000039	10209,00
000040	000040	000040	10209,00	10209,00	0,00	0,00	0,00	000040	10209,00	000040	10209,00
000041	000041	000041	10209,00	10209,00	0,00	0,00	0,00	000041	10209,00	000041	10209,00
000042	000042	000042	10209,00	10209,00	0,00	0,00	0,00	000042	10209,00	000042	10209,00
000043	000043	000043	10209,00	10209,00	0,00	0,00	0,00	000043	10209,00	000043	10209,00
000044	000044	000044	10209,00	10209,00	0,00	0,00	0,00	000044	10209,00	000044	10209,00
000045	000045	000045	10209,00	10209,00	0,00	0,00	0,00	000045	10209,00	000045	10209,00
000046	000046	000046	10209,00	10209,00	0,00	0,00	0,00	000046	10209,00	000046	10209,00
000047	000047	000047	10209,00	10209,00	0,00	0,00	0,00	000047	10209,00	000047	10209,00
000048	000048	000048	10209,00	10209,00	0,00	0,00	0,00	000048	10209,00	000048	10209,00
000049	000049	000049	10209,00	10209,00	0,00	0,00	0,00	000049	10209,00	000049	10209,00
000050	000050	000050	10209,00	10209,00	0,00	0,00	0,00	000050	10209,00	000050	10209,00
000051	000051	000051	10209,00	10209,00	0,00	0,00	0,00	000051	10209,00	000051	10209,00
000052	000052	000052	10209,00	10209,00	0,00	0,00	0,00	000052	10209,00	000052	10209,00
000053	000053	000053	10209,00	10209,00	0,00	0,00	0,00	000053	10209,00	000053	10209,00
000054	000054	000054	10209,00	10209,00	0,00	0,00	0,00	000054	10209,00	000054	10209,00
000055	000055	000055	10209,00	10209,00	0,00	0,00	0,00	000055	10209,00	000055	10209,00
000056	000056	000056	10209,00	10209,00	0,00	0,00	0,00	000056	10209,00	000056	10209,00
000057	000057	000057	10209,00	10209,00	0,00	0,00	0,00	000057	10209,00	000057	10209,00
000058	000058	000058	10209,00	10209,00	0,00	0,00	0,00	000058	10209,00	000058	10209,00
000059	000059	000059	10209,00	10209,00	0,00	0,00	0,00	000059	10209,00	000059	10209,00
000060	000060	000060	10209,00	10209,00	0,00	0,00	0,00	000060	10209,00	000060	10209,00
000061	000061	000061	10209,00	10209,00	0,00	0,00	0,00	000061	10209,00	000061	10209,00
000062	000062	000062	10209,00	10209,00	0,00	0,00	0,00	000062	10209,00	000062	10209,00
000063	000063	000063	10209,00	10209,00	0,00	0,00	0,00	000063	10209,00	000063	10209,00
000064	000064	000064	10209,00	10209,00	0,00	0,00	0,00	000064	10209,00	000064	10209,00
000065	000065	000065	10209,00	10209,00	0,00	0,00	0,00	000065	10209,00	000065	10209,00
000066	000066	000066	10209,00	10209,00	0,00	0,00	0,00	000066	10209,00	000066	10209,00
000067	000067	000067	10209,00	10209,00	0,00	0,00	0,00	000067	10209,00	000067	10209,00
000068	000068	000068	10209,00	10209,00	0,00	0,00	0,00	000068	10209,00	000068	10209,00
000069	000069	000069	10209,00	10209,00	0,00	0,00	0,00	000069	10209,00	000069	10209,00
000070	000070	000070	10209,00	10209,00	0,00	0,00	0,00	000070	10209,00	000070	10209,00
000071	000071	000071	10209,00	10209,00	0,00	0,00	0,00	000071	10209,00	000071	10209,00
000072	000072	000072	10209,00	10209,00	0,00	0,00	0,00	000072	10209,00	000072	10209,00
000073	000073	000073	10209,00	10209,00	0,00	0,00	0,00	000073	10209,00	000073	10209,00
000074	000074	000074	10209,00	10209,00	0,00	0,00	0,00	000074	10209,00	000074	10209,00
000075	000075	000075	10209,00	10209,00	0,00	0,00	0,00	000075	10209,00	000075	10209,00
000076	000076	000076	10209,00	10209,00	0,00	0,00	0,00	000076	10209,00	000076	10209,00
000077	000077	000077	10209,00								

# NOTICE - Archiving of log book data in Slovakia

We would like to remind you of a legal requirement which came into effect in **2022 in Slovakia**, stating that **log book data must be retained for a period of 10 years**.

Our product includes **5 years of data archiving** as part of the standard base price.

If you need to meet legal requirements and retain your data for a longer period, we offer the option to extend the archiving period.

If you are interested in extending the archiving period, please contact us—you will need to reach out to your sales representative or our technical support team at +420 233 555 111.

Based on your request, we will be happy to adjust the archiving period for an additional fee.

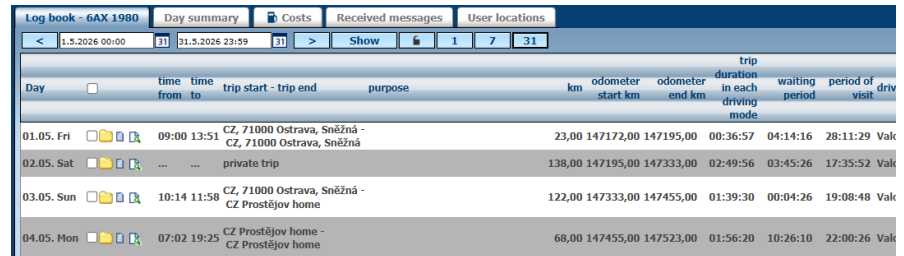

Day	time from	time to	trip start - trip end	purpose	km	odometer start km	odometer end km	trip duration in each driving mode	waiting period	period of visit	driv
01.05. Fri	09:00	13:51	CZ, 71000 Ostrava, Sněžná - CZ, 71000 Ostrava, Sněžná		23,00	147172,00	147195,00	00:36:57	04:14:16	28:11:29	Valc
02.05. Sat	...	...	private trip		138,00	147195,00	147333,00	02:49:56	03:45:26	17:35:52	Valc
03.05. Sun	10:14	11:58	CZ, 71000 Ostrava, Sněžná - CZ Prostějov home		122,00	147333,00	147455,00	01:39:30	00:04:26	19:08:48	Valc
04.05. Mon	07:02	19:25	CZ Prostějov home - CZ Prostějov home		68,00	147455,00	147523,00	01:56:20	10:26:10	22:00:26	Valc



END

**We hope that you have found useful information in the articles in this issue of the magazine that will make working with your fleet even easier.**

**Thank you for your trust.**

## CONTACTS

### **System provider**

**PRINCIP a.s.**  
Na Vítězné pláni 1719/4  
140 00 Praha 4  
IČ 41690311 DIČ CZ41690311

### **Working hours**

**Mo - Fr**            07:30 – 16:30

### **SW technical support**

**Princip a.s. – establishment Olomouc**  
Ladova 389/10  
779 00 Olomouc

**Phone: +420 233 555 111**

**Email:**

**[webdispecink.tlm@eurowag.com](mailto:webdispecink.tlm@eurowag.com)**  
**[www.webdispecink.cz](http://www.webdispecink.cz)**

